



## Wireless Remote Control For Direct Damper Control

## User Manual Model WRC

Made in USA

### Introduction

The WRC can control airflow from 1024 different wireless dampers installed on ceiling diffusers or registers. Each damper is programmed from the WRC with a Zone number from 1 to 32 and an Address from 1 to 32. Typically, a single WRC would control up to 32 different diffusers or dampers with the same Address. If more than 32 diffusers need to be controlled in a single building, work spaces or floors in that building could be assigned to different Addresses and another WRC used for that floor or work space.

The actuator/damper can be digitally set to any airflow from 0% (fully closed) to 100% (fully open) using the WRC. The remote remembers the setting for each zone when the zone is selected.

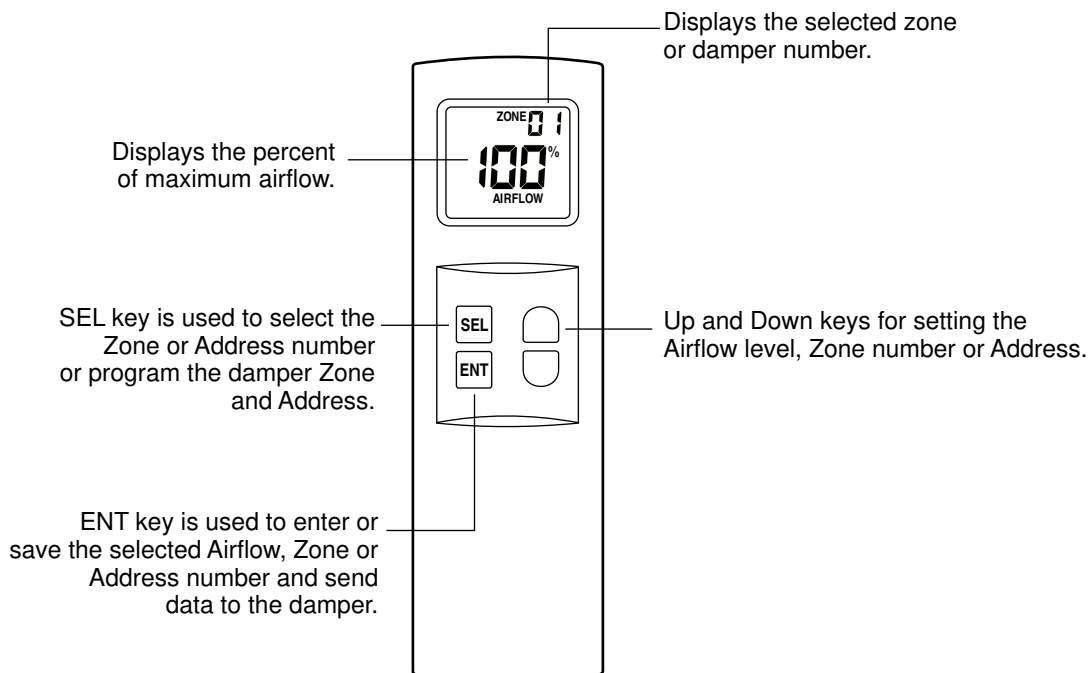



## Selecting the Zone Number

Press and release the SEL key and the LCD will show the Zone number. Use the Up and Down keys to change the Zone number, and press the ENT key. The new Zone number and Airflow will be displayed. Zones or diffusers are numbered 1 to 32.

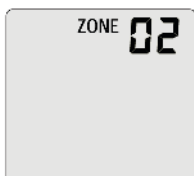

## Adjusting Airflow

After selecting the Zone number, press the Up and Down keys to set the Airflow. Pressing the ENT key sends the new Airflow setting to the WCD Damper.

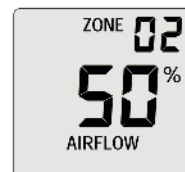

## Selecting the Address Number

Select a unique address number corresponding to the department, floor or building. Press and release the SEL key twice and the LCD will show the Address number. Use the Up and Down keys to select the Address, and press the ENT key.

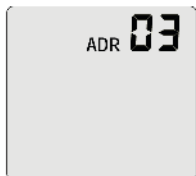

## Low Battery Warning

When batteries are low, the display will show "Lob" and the batteries should be changed. Lithium AAA batteries should be used for longer life.

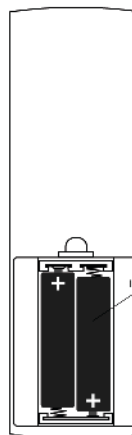
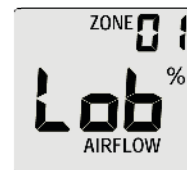

Remove battery cover and install two AAA batteries as shown.

## Setting the Damper Zone and Home Address

The WCD Damper Actuator must be programmed to receive the remote commands corresponding to the selected Zone and Address numbers. After selecting the Zone and Address numbers as previously described, press the small pushbutton switch on the WCD Damper Actuator. The LED will alternately blink red and green. During the next 30 seconds, the Zone and Address can be programmed into the WCD Damper Actuator.

Press and release the SEL key three times until PRG DPR appears in the lower left corner of the LCD. Press the ENT key and the WCD Damper will be programmed with the Zone and Address number.

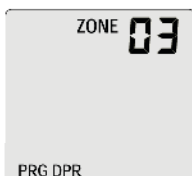

## 3-Year Limited Warranty

This is a "Limited Warranty" which gives you specific rights. You may have other rights which vary from state to state.

For a period of three years from the date of purchase, any malfunction caused by factory defective parts or workmanship will be corrected at no cost to you. See the complete Warranty at eControlsUSA.com.